

# SLITTING SAW SERIES

# Slitting Saw Series

SLITTING  
S A W  
SERIES





### Slitting Saw Series

<b>SS045...series</b>	45M/M	<b>346</b>
<b>SS050...series</b>	50M/M	<b>347</b>
<b>SS060...series</b>	60M/M	<b>348</b>
<b>SS070...series</b>	70M/M	<b>349</b>
<b>SS075...series</b>	75M/M	<b>350</b>
<b>SS080...series</b>	80M/M	<b>351</b>
<b>SS090...series</b>	90M/M	<b>352</b>
<b>SS100...series</b>	100M/M	<b>353</b>
<b>SS125...series</b>	125M/M	<b>354</b>

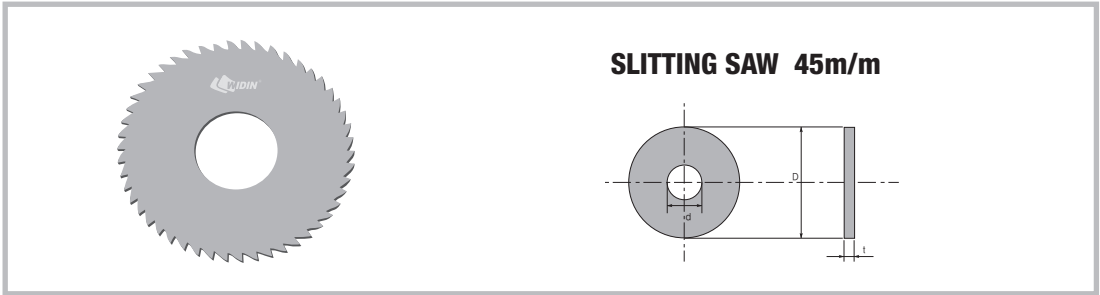

## SS045...series

(UNIT : mm)

EDP. No.	D	d	t	NT	TYPE	STOCK
SS045 030	45	15.875	0.3	50	B	
SS045 050	45	15.875	0.5	50	B	
SS045 080	45	15.875	0.8	50	B	
SS045 100	45	15.875	1.0	50	B	
SS045 120	45	15.875	1.2	50	B	
SS045 150	45	15.875	1.5	50	B	
SS045 200	45	15.875	2.0	50	B	
SS045 250	45	15.875	2.5	50	B	
SS045 300	45	15.875	3.0	50	B	
SS045 350	45	15.875	3.5	50	B	
SS045 400	45	15.875	4.0	50	B	
SS045 450	45	15.875	4.5	50	B	
SS045 500	45	15.875	5.0	50	B	

A TYPE



B TYPE



C TYPE



※ NT = Number of Teeth

※ A or C type is according to request.

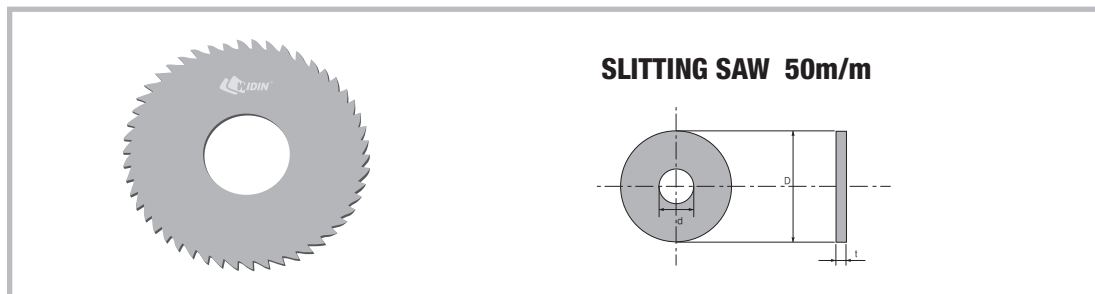

## SS050...series

(UNIT : mm)

EDP. No.	D	d	t	NT	TYPE	STOCK
SS050 030	50	15.875	0.3	50	B	
SS050 050	50	15.875	0.5	50	B	
SS050 080	50	15.875	0.8	50	B	
SS050 100	50	15.875	1.0	50	B	
SS050 120	50	15.875	1.2	50	B	
SS050 150	50	15.875	1.5	50	B	
SS050 200	50	15.875	2.0	50	B	
SS050 250	50	15.875	2.5	50	B	
SS050 300	50	15.875	3.0	50	B	
SS050 350	50	15.875	3.5	50	B	
SS050 400	50	15.875	4.0	50	B	
SS050 450	50	15.875	4.5	50	B	
SS050 500	50	15.875	5.0	50	B	

A TYPE



B TYPE



C TYPE



※ NT = Number of Teeth

※ A or C type is according to request.



## SLITTING SAW 60m/m

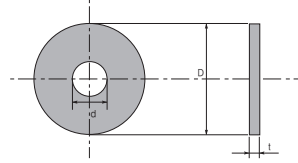

## SS060...series

(UNIT : mm)

EDP. No.	D	d	t	NT	TYPE	STOCK
SS060 030	60	15.875	0.3	70	B	
SS060 050	60	15.875	0.5	70	B	
SS060 080	60	15.875	0.8	70	B	
SS060 100	60	15.875	1.0	70	B	
SS060 120	60	15.875	1.2	70	B	
SS060 150	60	15.875	1.5	70	B	
SS060 200	60	15.875	2.0	70	B	
SS060 250	60	15.875	2.5	70	B	
SS060 300	60	15.875	3.0	70	B	
SS060 350	60	15.875	3.5	70	B	
SS060 400	60	15.875	4.0	70	B	
SS060 450	60	15.875	4.5	70	B	
SS060 500	60	15.875	5.0	70	B	

A TYPE



B TYPE



C TYPE



※ NT = Number of Teeth

※ A or C type is according to request.

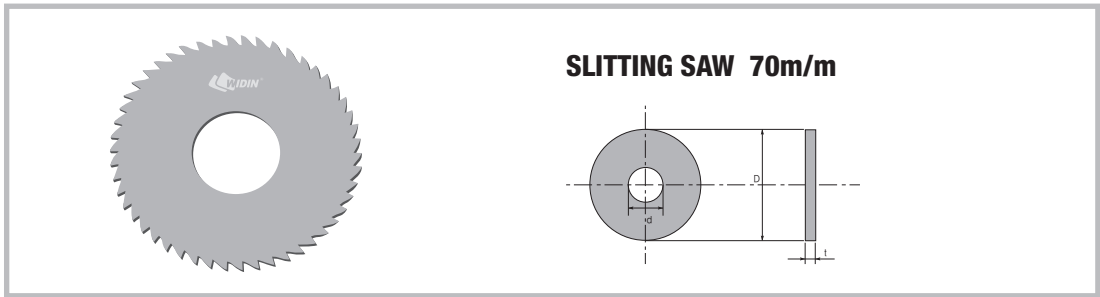

## SS070...series

(UNIT : mm)

EDP. No.	D	d	t	NT	TYPE	STOCK
SS070 030	70	25.4	0.3	72	B	
SS070 050	70	25.4	0.5	72	B	
SS070 080	70	25.4	0.8	72	B	
SS070 100	70	25.4	1.0	72	B	
SS070 120	70	25.4	1.2	72	B	
SS070 150	70	25.4	1.5	72	B	
SS070 200	70	25.4	2.0	72	B	
SS070 250	70	25.4	2.5	72	B	
SS070 300	70	25.4	3.0	72	B	
SS070 350	70	25.4	3.5	72	B	
SS070 400	70	25.4	4.0	72	B	
SS070 450	70	25.4	4.5	72	B	
SS070 500	70	25.4	5.0	72	B	

A TYPE



B TYPE



C TYPE



※ NT = Number of Teeth

※ A or C type is according to request.

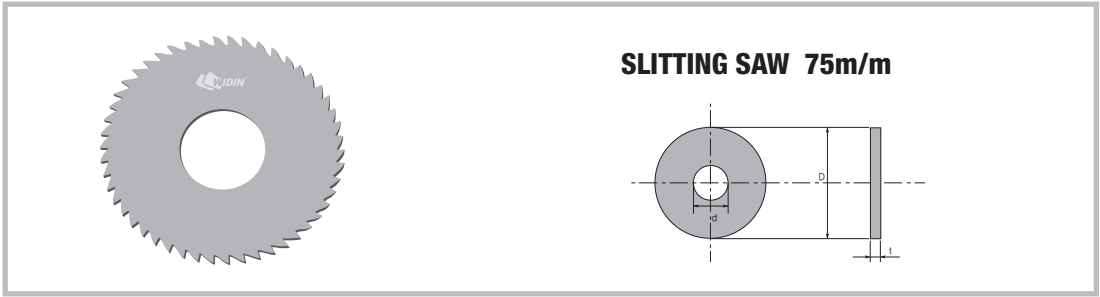
**SS075...series**

(UNIT : mm)

EDP. No.	D	d	t	NT	TYPE	STOCK
SS075 030	75	25.4	0.3	72	B	
SS075 050	75	25.4	0.5	72	B	
SS075 080	75	25.4	0.8	72	B	
SS075 100	75	25.4	1.0	72	B	
SS075 120	75	25.4	1.2	72	B	
SS075 150	75	25.4	1.5	72	B	
SS075 200	75	25.4	2.0	72	B	
SS075 250	75	25.4	2.5	72	B	
SS075 300	75	25.4	3.0	72	B	
SS075 350	75	25.4	3.5	72	B	
SS075 400	75	25.4	4.0	72	B	
SS075 450	75	25.4	4.5	72	B	
SS075 500	75	25.4	5.0	72	B	

A TYPE



B TYPE



C TYPE



※ NT = Number of Teeth

※ A or C type is according to request.



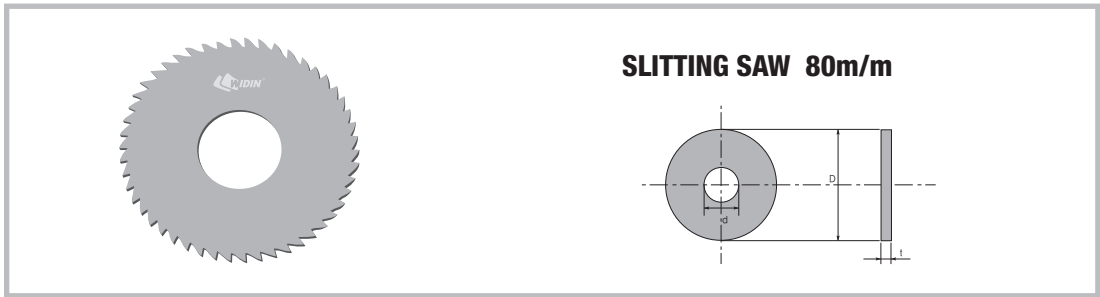

## SS080...series

(UNIT : mm)

EDP. No.	D	d	t	NT	TYPE	STOCK
SS080 030	80	25.4	0.3	80	B	
SS080 050	80	25.4	0.5	80	B	
SS080 080	80	25.4	0.8	80	B	
SS080 100	80	25.4	1.0	80	B	
SS080 120	80	25.4	1.2	80	B	
SS080 150	80	25.4	1.5	80	B	
SS080 200	80	25.4	2.0	80	B	
SS080 250	80	25.4	2.5	80	B	
SS080 300	80	25.4	3.0	80	B	
SS080 350	80	25.4	3.5	80	B	
SS080 400	80	25.4	4.0	80	B	
SS080 450	80	25.4	4.5	80	B	
SS080 500	80	25.4	5.0	80	B	

A TYPE



B TYPE



C TYPE



※ NT = Number of Teeth

※ A or C type is according to request.

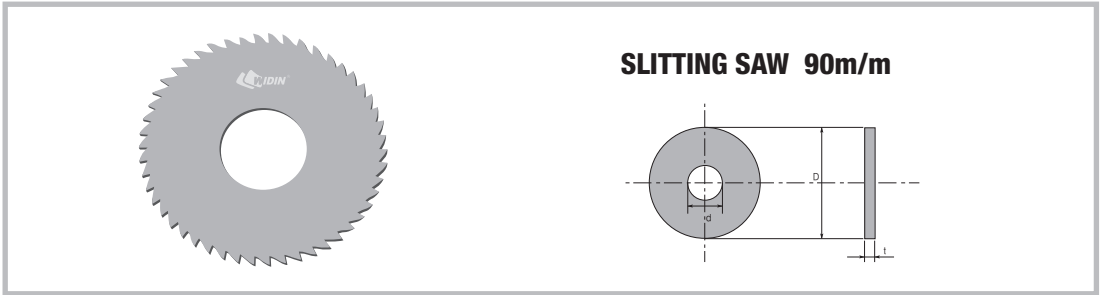

## SS090...series

(UNIT : mm)

EDP. No.	D	d	t	NT	TYPE	STOCK
SS090 030	90	25.4	0.3	90	B	
SS090 050	90	25.4	0.5	90	B	
SS090 080	90	25.4	0.8	90	B	
SS090 100	90	25.4	1.0	90	B	
SS090 120	90	25.4	1.2	90	B	
SS090 150	90	25.4	1.5	90	B	
SS090 200	90	25.4	2.0	90	B	
SS090 250	90	25.4	2.5	90	B	
SS090 300	90	25.4	3.0	90	B	
SS090 350	90	25.4	3.5	90	B	
SS090 400	90	25.4	4.0	90	B	
SS090 450	90	25.4	4.5	90	B	
SS090 500	90	25.4	5.0	90	B	

A TYPE



B TYPE



C TYPE



※ NT = Number of Teeth

※ A or C type is according to request.

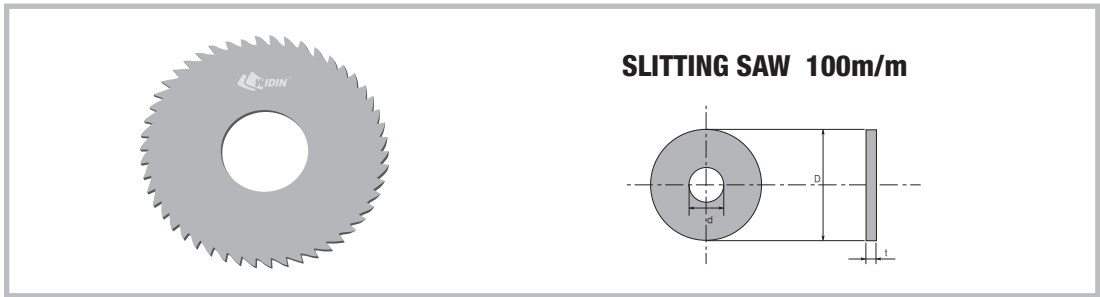

## SS100...series

(UNIT : mm)

EDP. No.	D	d	t	NT	TYPE	STOCK
SS100 030	100	25.4	0.3	120	B	
SS100 050	100	25.4	0.5	120	B	
SS100 080	100	25.4	0.8	120	B	
SS100 100	100	25.4	1.0	120	B	
SS100 120	100	25.4	1.2	120	B	
SS100 150	100	25.4	1.5	120	B	
SS100 200	100	25.4	2.0	120	B	
SS100 250	100	25.4	2.5	120	B	
SS100 300	100	25.4	3.0	120	B	
SS100 350	100	25.4	3.5	120	B	
SS100 400	100	25.4	4.0	120	B	
SS100 450	100	25.4	4.5	120	B	
SS100 500	100	25.4	5.0	120	B	

A TYPE



B TYPE



C TYPE



※ NT = Number of Teeth

※ A or C type is according to request.

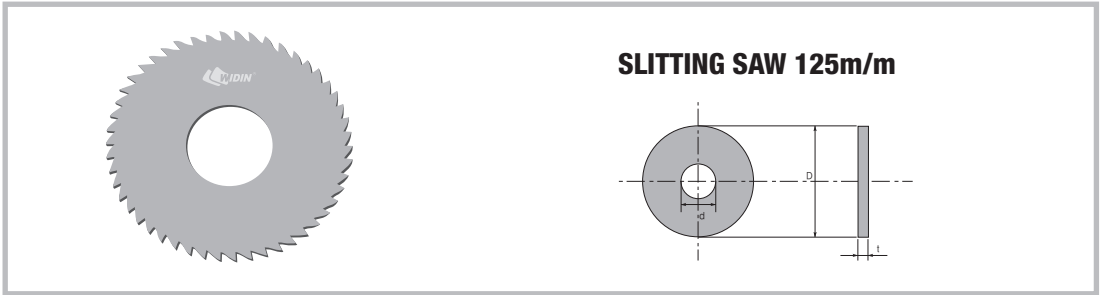

SLITTING SAW 125m/m

**SS125...series**

(UNIT : mm)

EDP. No.	D	d	t	NT	TYPE	STOCK
SS125 080	125	31.75	0.8	120	B	
SS125 100	125	31.75	1.0	120	B	
SS125 120	125	31.75	1.2	120	B	
SS125 150	125	31.75	1.5	120	B	
SS125 200	125	31.75	2.0	120	B	
SS125 250	125	31.75	2.5	120	B	
SS125 300	125	31.75	3.0	120	B	
SS125 350	125	31.75	3.5	120	B	
SS125 400	125	31.75	4.0	120	B	
SS125 450	125	31.75	4.5	120	B	
SS125 500	125	31.75	5.0	120	B	

A TYPE



B TYPE



C TYPE



※ NT = Number of Teeth

※ A or C type is according to request.