

# DC Slim Chuck



**DIN69871 SK40**

**Features:**

- Runout: <math><5\mu\text{m}</math>(4xD)
- Smallest outside diameter  $\phi 13$
- Max speed: 20,000 r.p.m.; G2.5.
- Collet chuck designed without nut and with inner-holding collet. This can have strong stiffness rigidity and high stability.

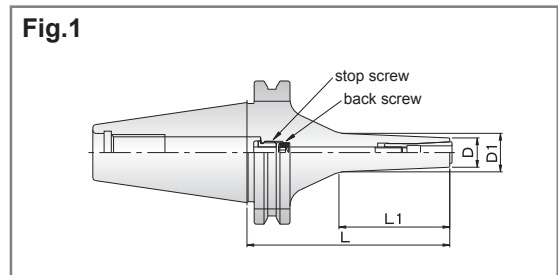

Ordering Code	Type of Holder	L	L1	$\phi D$	D1	Max r.p.m.	Hexagon Key	Back Screw	Stop Screw
0-342090-202	SK40-DC6-60	60	25	13	16	20,000	0-301940-642	M5 * L40	OP-M10
-204	SK40-DC6-90	90	48	13	18	20,000		M5 * L40	OP-M10
-206	SK40-DC6-120	120	62	13	19	20,000	0-301940-644	M5 * L40	OP-M10
-208	SK40-DC6-150	150	88	13	22	20,000		M5 * L95	OP-M10

**DIN 69893 HSK form A**

**Features:**

- Runout: <math><5\mu\text{m}</math>(4xD)
- Smallest outside diameter  $\phi 13$
- Max speed: 30,000 r.p.m.; G2.5.
- Collet chuck designed without nut and with inner-holding collet. This can have strong stiffness rigidity and high stability.

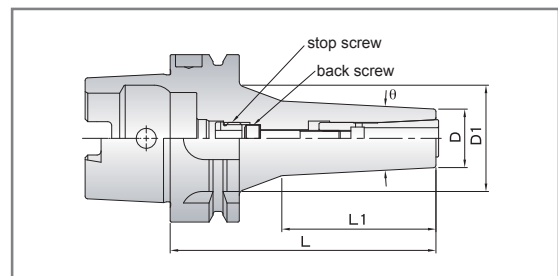

Ordering Code	Type of Holder	Gripping Range	L	L1	$\phi D$	D1	$\Theta$	Max r.p.m.	Hexagon Key	Back Screw	Stop Screw
0-306090-202	HSK63A-DC6-75	2~6	75	34	13	--	6°	30,000	0-301940-642	M5 * L20	OP-M10
-204	HSK63A-DC6-95	2~6	95	45	13	46	6°	30,000		M5 * L20	OP-M10
-206	HSK63A-DC6-120	2~6	120	53	13	48	6°	30,000		M5 * L40	OP-M10
-208	HSK63A-DC6-150	2~6	150	80	13	45	6°	30,000	0-301940-644	M5 * L80	OP-M10
-302	HSK63A-DC8-100	3~8	100	58	22	48	6°	30,000	0-301940-653	M6 * L25	OP-M12
-402	HSK63A-DC10-110	3~10	110	55	28	48	--	30,000	0-301940-663	M8 * L30	OP-M16
-502	HSK63A-DC12-120	3~12	120	55	34	50	--	30,000	0-301940-683	M10 * L35	OP-M18

## MAS/BT(JIS B 6339)

### Features:

- Runout: <math>< 5\mu\text{m}</math>(4xD)
- Smallest outside diameter  $\phi 13$
- Max speed: 30,000 r.p.m.; G2.5.
- Collet chuck designed without nut and with inner-holding collet. This can have strong stiffness rigidity and high stability.

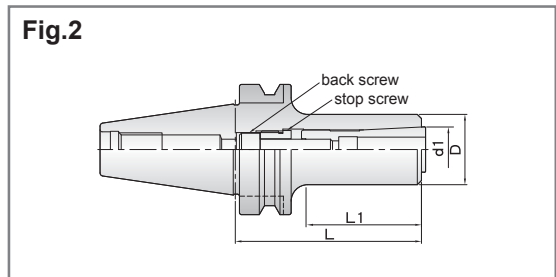
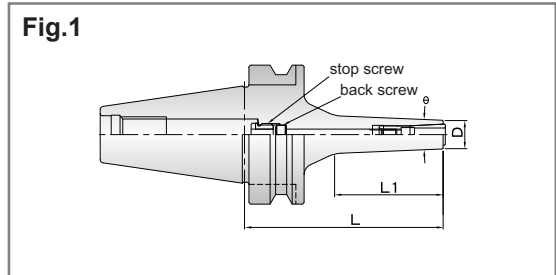

Ordering Code	Type of Holder	Gripping Range	L	L1	$\phi D$	$\theta$	Fig	Collet	Max r.p.m.	Hexagon Key	Back Screw	Stop Screw
0-330090-202	BT30-DC6-60	2~6	60	26	13	3°	1	DC6	30,000	0-301940-642	M5 * L40	OP-M10
-204	DC6-90	2~6	90	50	13	3°	1	DC6	30,000		M5 * L40	OP-M10
-502	DC12-70	3~12	70	45	34	--	2	DC12	30,000		0-301940-683	M10 * L35
0-340090-202	BT40-DC6-60	2~6	60	26	13	3°	1	DC6	30,000	0-301940-642	M5 * L40	OP-M10
-204	DC6-90	2~6	90	45	13	3°	1	DC6	30,000		M5 * L40	OP-M10
-206	DC6-120	2~6	120	60	13	3°	1	DC6	30,000	0-301940-644	M5 * L40	OP-M10
-208	DC6-150	2~6	150	76	13	3°	1	DC6	30,000		M5 * L90	OP-M10
-302	DC8-90	3~8	90	53	22	3°	1	DC8	30,000	0-301940-653	M6 * L25	OP-M12
-304	DC8-120	3~8	120	65	22	3°	1	DC8	30,000		M6 * L25	OP-M12
-402	DC10-90	3~10	90	51	28	--	2	DC10	30,000	0-301940-663	M8 * L30	OP-M16
-404	DC10-120	3~10	120	60	28	--	2	DC10	30,000		M8 * L30	OP-M16
-502	DC12-70	3~12	70	35	34	3°	2	DC12	30,000	0-301940-683	M10 * L35	OP-M18
-504	DC12-90	3~12	90	55	34	--	2	DC12	30,000		M10 * L35	OP-M18
-506	DC12-120	3~12	120	85	34	--	2	DC12	30,000		M10 * L35	OP-M18
-508	DC12-150	3~12	150	90	34	--	2	DC12	30,000		M10 * L35	OP-M18
0-350090-402	BT50-DC10-110	3~10	110	57	28	--	2	DC10	20,000	0-301940-663	M8 * L30	OP-M16
-404	DC10-150	3~10	150	75	28	--	2	DC10	20,000	0-301940-664	M8 * L30	OP-M16
-502	DC12-110	3~12	110	57	34	--	2	DC12	20,000	0-301940-683	M10 * L35	OP-M18
-504	DC12-150	3~12	150	70	34	--	2	DC12	20,000	0-301940-684	M10 * L35	OP-M18

Extension Adaptor

**Features:**

- Slim collet chuck designed without nut can get the smallest outside diameter of  $\varnothing 8.6\text{mm}$ . This can achieve the best effect on extended processing depth.
- Varies lengths of slim chuck provides different choices, the longest chuck is up to 300mm.

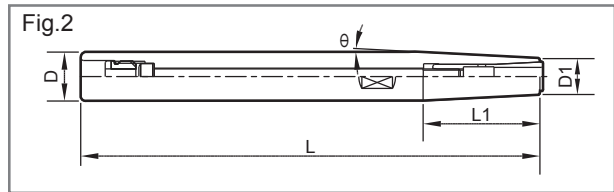
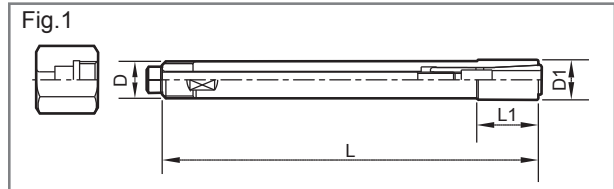

Ordering Code	Type of Holder	Fig	d	L	L1	$\varnothing D$	D1	$\theta$	Collet	Hexagon Key	Back Screw	Stop Screw	Stop Nut
0-329090-102	ST10-DC4-90	1	2~4	90	14.32	10	9	2°	DC4	0-301940~632	M4 * L70	--	TP-M8
-112	ST12-DC4-120	2	2~4	120	38	12	9	3°	DC4	0-301940~632	M4 * L85	OP-M8	--
0-329090-212	ST12-DC6-120	1	2~6	120	40	12	14	--	DC6	0-301940~642	M5 * L95	--	TP-M12
-222	ST16-DC6-150	2	2~6	150	38	16	14	3°	DC6		M5 * L100	OP-M10	--
-232	ST20-DC6-200	2	2~6	200	70	20	14	3°	DC6		M5 * L100	OP-M10	--
-242	ST25-DC6-250	2	2~6	250	115	25	14	3°	DC6		0-301940~643	M5 * L100	OP-M10
0-329090-322	ST20-DC8-200	2	3~8	200	28	20	19	2°	DC8	0-301940~652	M6 * L120	OP-M12	--
0-329090-432	ST25-DC10-250	2	3~10	250	28	25	24	2°	DC10	0-301940~662	M8 * L150	OP-M16	--
0-329090-532	ST32-DC12-300	2	3~12	300	57	32	28	2°	DC12	0-301940~682	M10 * L150	OP-M18	--

**Extension Adaptor**
**DC 4**

Ordering Code	Type of Holder	Contains			
		Collet Chuck	Collet	Opener	Hexagon Key
0-329090-1123	SST12-DC4-120	ST12-DC4-120	DC4-2E x 1pc DC4-3E x 1pc DC4-4E x 1pc	0-301940~002	0-301940~632
-4123	SST10-DC4-90	ST10-DC4-90			
-5123	SST1012-DC4	ST10-DC4-90 ST12-DC4-120			

**DC 6**

Ordering Code	Type of Holder	Contains			
		Collet Chuck	Collet	Opener	Hexagon Key
0-329090-0223	SST12-DC6-120	ST12-DC6-120	DC6-3E x 1pc DC6-4E x 1pc DC6-6E x 1pc	0-301940~002	0-301940~642
-1223	SST16-DC6-150	ST16-DC6-150			0-301940~642
-2223	SST20-DC6-200	ST20-DC6-200			0-301940~642
-3223	SST25-DC6-250	ST25-DC6-250			0-301940~643
-4223	SST1216-DC6	ST12-DC6-120			0-301940~642
		ST16-DC6-150			0-301940~642
-5223	SST2025-DC6	ST20-DC6-200			0-301940~642
		ST25-DC6-250	0-301940~643		

**DC 8**

Ordering Code	Type of Holder	Contains			
		Collet Chuck	Collet	Opener	Hexagon Key
0-329090-2323	SST20-DC8-200	ST20-DC8-200	DC8-3E x 1pc DC8-4E x 1pc DC8-6E x 1pc DC8-8E x 1pc	0-301940~002	0-301940~652

**DC 10**

Ordering Code	Type of Holder	Contains			
		Collet Chuck	Collet	Opener	Hexagon Key
0-329090-3423	SST25-DC10-250	ST25-DC10-250	DC10-3E x 1pc DC10-4E x 1pc DC10-6E x 1pc DC10-8E x 1pc DC10-10E x 1pc	0-301940~002	0-301940~662

**DC 12**

Ordering Code	Type of Holder	Contains			
		Collet Chuck	Collet	Opener	Hexagon Key
0-329090-3523	SST32-DC12-300	ST32-DC12-300	DC12-3E x 1pc DC12-4E x 1pc DC12-6E x 1pc DC12-8E x 1pc DC12-10E x 1pc DC12-12E x 1pc	0-301940~927	0-301940~682

**DC-E Collet**

**Features:**

- The design of DC-E collets is emphasized on increasing the clamping force of end mills.



Runout <math>< 5\mu\text{m}</math>

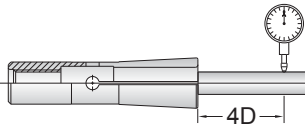

Type	DC4	DC6	DC8	DC10	DC12
D	7	9.6	15	19.1	22
L	31	36	45	52	60

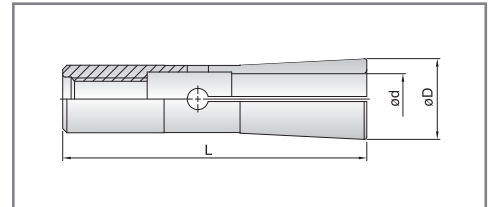

DC4		DC6		DC8		DC10		DC12	
Ordering Code	Size (mm)	Ordering Code	Size (mm)	Ordering Code	Size (mm)	Ordering Code	Size (mm)	Ordering Code	Size (mm)
0-300090-102	2.0	0-300090-203	3.0	0-300090-303	3.0	0-300090-403	3.0	0-300090-503	3.0
0-300090-103	3.0	0-300090-204	4.0	0-300090-304	4.0	0-300090-404	4.0	0-300090-504	4.0
0-300090-104	4.0	0-300090-206	6.0	0-300090-306	6.0	0-300090-406	6.0	0-300090-506	6.0
				0-300090-308	8.0	0-300090-408	8.0	0-300090-508	8.0
						0-300090-410	10.0	0-300090-510	10.0
								0-300090-512	12.0

Size: DC4, DC6 diameter 3.175 is available on request.  
Order example: 300090-102 DC4-2E

**DC Collet**

**Features:**

- DC6 collets can clamp any type of drills, reamers and taps below  $\phi 6\text{mm}$ .
- Gripping range of each type of collets is 0.25mm.

Runout <math>< 5\mu\text{m}</math>

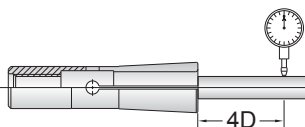

Type	DC6
D	9.8
L	36

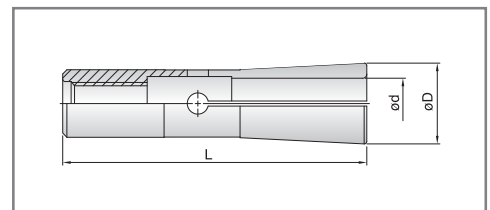

DC6			
Ordering Code	Size (mm)	Ordering Code	Size (mm)
0-300092-200	2	0-300092-425	4.25
-225	2.25	-450	4.5
-250	2.5	-475	4.75
-275	2.75	-500	5
-300	3	-525	5.25
-325	3.25	-550	5.5
-350	3.5	-575	5.75
-375	3.75	-600	6
-400	4		



Ordering Code	Type	ød	Quantity
0-300090-0405	SDC10E-5	3, 4, 6, 8, 10	5pcs
-0506	SDC12E-6	3, 4, 6, 8, 10, 12	6pcs
-0217	SDC6-17	2-6	17pcs

## Opener



Ordering Code
0-301940-002

## Hexagon Key



Ordering Code	mm	L
0-301940-632	3	100
-642	4	100
-643	4	150
-652	5	100
-662	6	100
-682	8	100

## Back Screw



Ordering Code	Type	Thread	L
0-301940-0460	M4 * L60	M4	60
-0485	M4 * L85	M4	85
-0555	M5 * L55	M5	55
-0595	M5 * L95	M5	95
-05100	M5 * L100	M5	100
-0670	M6 * L70	M6	70
-06120	M6 * L120	M6	120
-0880	M8 * L80	M8	80
-08100	M8 * L100	M8	100
-08150	M8 * L150	M8	150
-10120	M10 * L120	M10	120
-10150	M10 * L150	M10	150

## Stop Screw



Ordering Code	Type	Thread
0-301940-OPM8	OP-M8	M8(L)
-OPM10	OP-M10	M10(L)
-OPM12	OP-M12	M12(L)
-OPM16	OP-M16	M16(L)
-OPM18	OP-M18	M18(L)

Thread of stop screw is left-hand thread.

## Stop Nut



Ordering Code	Type	Thread
0-301940-TPM8	TP-M8	M8(L)
-TPM12A	TP-M12A	M12(L)
-TPM12	TP-M12	M12(L)

Thread of stop nut is left-hand thread.

# DC Slim Chuck

---



## **Jimmore International Corp.**

No.120-2, Sec.2 Fusing Rd., South District,  
Taichung City 40252, Taiwan

TEL: +886-(0)4-22605352 FAX: +886-(0)4-22608765

E-mail: [info@jimmore.com.tw](mailto:info@jimmore.com.tw) ; [jimmore@seed.net.tw](mailto:jimmore@seed.net.tw)

<http://www.jic-tools.com.tw>